

GENERAL NOTES

1. THE LANDSCAPING CHARACTER AREA FOR THE SITE IS: NORTH NANAIMO.
2. REFER TO SITE PLAN PREPARED BY HUMAN STUDIO ARCHITECTURE + URBAN DESIGN FOR SITE PLAN LAYOUT, PROPOSED FINISHED FLOOR ELEVATIONS, EXTERIOR STAIRS AND OTHER ARCHITECTURAL INFORMATION.
3. REFER TO CIVIL PLANS AND REPORT PREPARED BY J.E. ANDERSON & ASSOCIATES FOR ALL SITE SERVICING, GRADING, DRAINAGE AND STORMWATER MANAGEMENT INFORMATION.
4. REFER TO TREE REMOVAL PERMIT APPLICATION PREPARED BY TOTH AND ASSOCIATES ENVIRONMENTAL SERVICES FOR ALL TREE REMOVAL AND REPLACEMENT INFORMATION.

TREE REPLACEMENT SUMMARY

1. REFER TO THE PLANTING PLAN AND PLANT LEGEND ON SHEET L2 FOR ADDITIONAL INFORMATION
2. REPLACEMENT TREES REQUIRED: 116
3. REPLACEMENT TREES PROVIDED: 14

GRADING LEGEND

SYMBOL	DESCRIPTION
-125	EXISTING CONTOURS - BY SURVEY
-126	EXISTING SPOT ELEVATION - BY SURVEY
123000	PROPOSED SPOT ELEVATION - PER ARCHITECTURE
121.75	PROPOSED SPOT ELEVATION - PER CIVIL
+ 100.00	PROPOSED SPOT ELEVATION - LANDSCAPE
+ TW 10.00	TOP OF WALL
+ BW 10.00	BOTTOM OF WALL
2% MIN.	DRAINAGE DIRECTION AND SLOPE

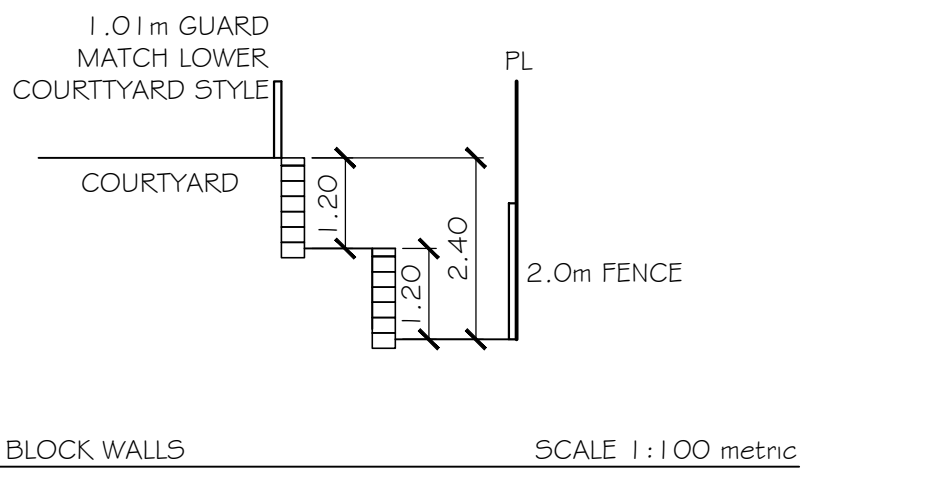
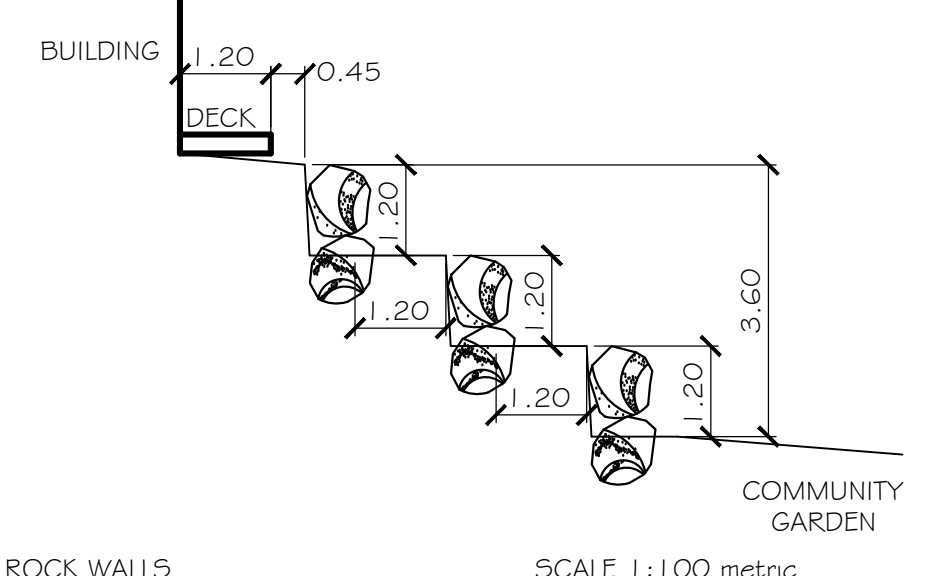

macdonald gray
 814 Shorewood Drive, Parksville, BC V9P 1S1
 TEL: 250 248-3089 EMAIL: info@macdonaldgray.ca
 www.macdonaldgray.ca

THIS DRAWING IS NOT FINAL AND SHALL NOT BE USED FOR CONSTRUCTION WORK UNTIL IT HAS BEEN STAMPED AND SIGNED BY THE LANDSCAPE ARCHITECT. THE COPYRIGHTS TO ALL DESIGNS AND DRAWINGS ARE THE PROPERTY OF MACDONALD GRAY CONSULTANTS INC. REPRODUCTION OR USE FOR ANY PURPOSE OTHER THAN THAT AUTHORIZED BY MACDONALD GRAY CONSULTANTS INC. IS FORBIDDEN.

RECEIVED
DP1357
2026-FEB-03
 Current Planning

Lost Lake Cohousing Inc.
Lost Lake Cohousing Inc.
5180 Universal Place, Nanaimo, BC

LANDSCAPE ARCHITECTURE PLAN

Date: January 29, 2026
 Drawn: CM
 Checked: CM
 Scale: 1:250 metric
 Project Number: 23-0341
 DRAWING NUMBER: **L1 of 6**

REVISION SCHEDULE	NOTES
#	Date
0	03JUN2024 DP Coordination
1	19JUN2024 DP Coordination
2	25JUN2024 Issued for DP
3	10APR2025 Reissued for DP
4	29JAN2026 Reissued for DP

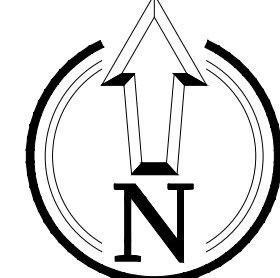

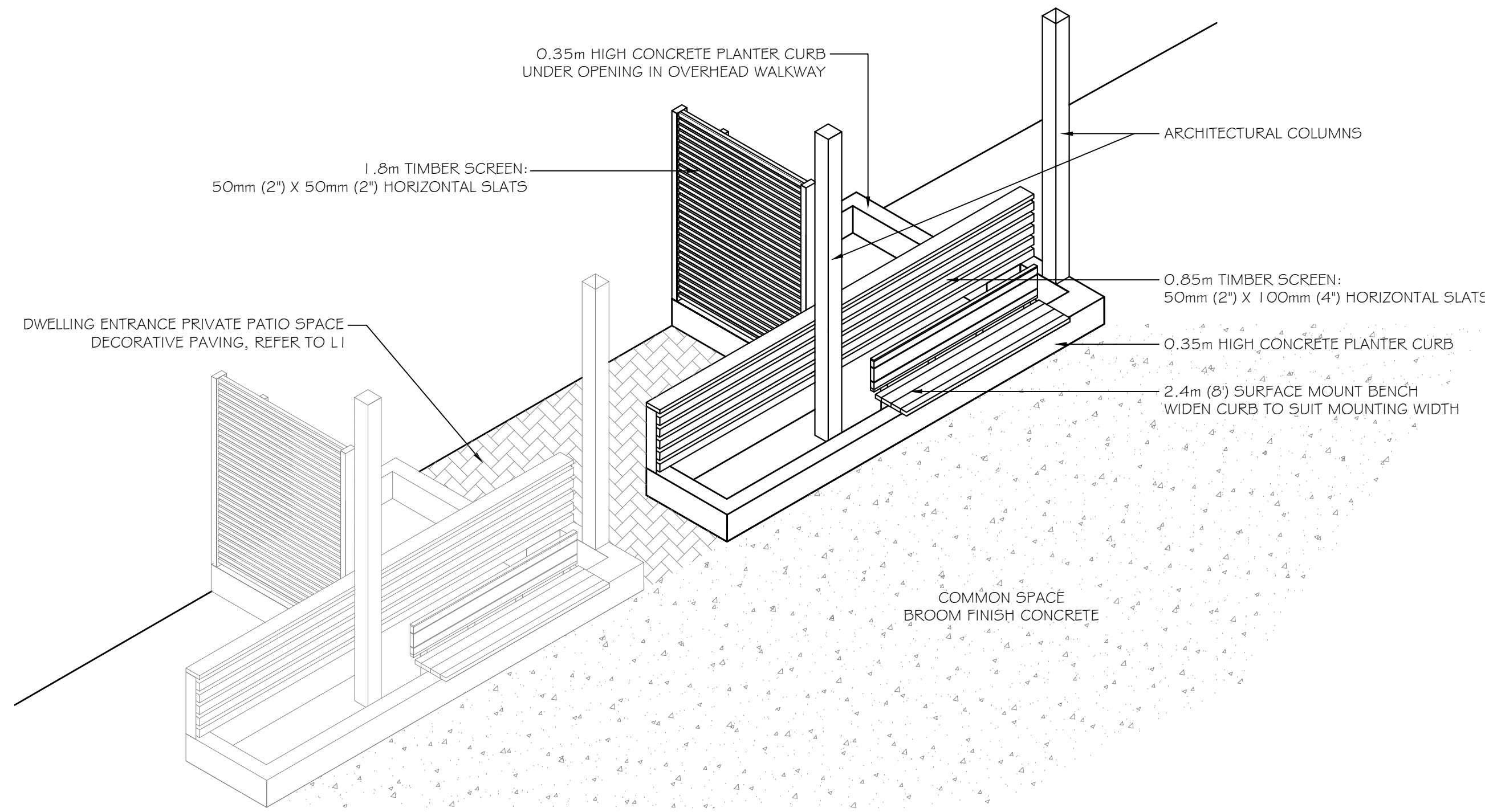

Lower Courtyard Sketch



Landscape Wall Style (1.2m Max. Height)

BESELT WALL TOP BENCH

Model Number : BVWTB-6 (6ft)



PRODUCT SPECIFICATIONS

100% Recycled Plastic Slats
This product will not rot, splinter, or warp reducing maintenance costs over the life of the product.
Colours Available: Black, Grey, Redwood, Sand, Walnut

10 YEAR LIMITED WARRANTY
Durable Powder Coated Aluminum Frame

Standard Colours: Brown Slate, Victor Ridge II, Nordic Lichen, Timeless Rust, Grey Gold, Textured Silver, Precious Sand, Groovy Red, Black Textured, Earth Clay, Noble Bronze, Modern Khaki, Flame Red, Pastel Orange, Signal Violet, Traffic Yellow, Ultramarine Blue, Water Blue, Yellow Green

Long Lasting Stainless Steel Hardware

CUSTOMIZED SOLUTIONS

Custom powder coating (Setup Charges May Apply)
Gifting program (Custom Inset Bronze Plaques)
Without armrests (BVWTNA-6)
Center armrest (BVWT-6C)
Custom lengths up to 8 ft
Skate blocks
INST-1 Stainless steel bolt down kit

PRODUCT DIMENSIONS

Height	17 5/16 inches / 438 mm
Depth	24 inches / 610 mm
Seat Depth	18.5 inches / 470 mm
Length	6 feet / 183 cm
Weight	144 lbs / 65 kg

RECYCLED CONTENT

42% RECYCLED CONTENT BY WEIGHT
100% RECYCLABLE

AVAILABLE RECYCLED PLASTIC LUMBER COLOURS

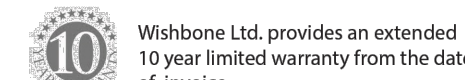
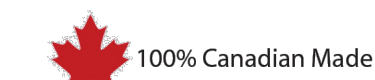

Visit us online at www.wishboneltd.com

Wishbone Site Furnishings | #210-27090 Gloucester Way | Langley, BC CANADA V4W 3Y5
1.866.626.0476 sales@wishboneltd.com

Lower Courtyard Bench Style

LOW VOLUME

Home > Low Volume > Single Arch

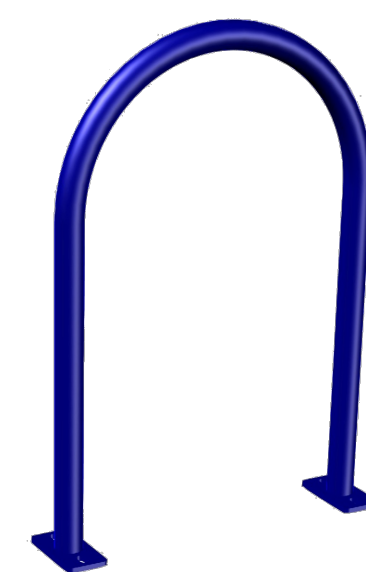

SPECIFICATION DOWNLOADS

CAD DRAWINGS [212.63 KB]
DETAILED SPECS [171.13 KB]

Single Arch

The Single Arch conveniently parks 2 bikes and maintains a slim profile when not in use. The Graphics Bar is left blank so customer can apply their own vinyl graphics. The Custom Logo Plate can be provided with laser-cut graphics or as a blank plate suitable for vinyl graphics (applied by customer). The Logo Plate size can be adjusted to suit the logo or graphics. Your sales representative can advise if your logo or text message is suitable for laser-cutting.

Please select from the following menus to customize the product for your quote submission.

FINISHES

Hot Dip Galvanized

Powder Coat

COLOURS



CLASSIC STANDARD

CLEAN LINES, SMOOTH PROFILE, AND MODULARITY RESULTS IN TIMELESS DESIGNS

- FEATURES & BENEFITS**
- 6 sizes for limitless design options
 - TextureGuard face mix colour profile
 - Available in 60mm and 80mm

SHAPES & SIZES

3:1 STANDARD	75 x 225 x 60mm 2 7/8" x 8 7/8" x 2 3/8"
HALF STANDARD	112.5 x 112.5 x 60mm 4 1/2" x 4 1/2" x 2 3/8"
STANDARD 60MM	112.5 x 225 x 60mm 4 1/2" x 8 7/8" x 2 3/8"
DOUBLE STANDARD 60MM	225 x 225 x 60mm 8 7/8" x 8 7/8" x 2 3/8"
CALIFORNIA	151 x 301 x 60mm 5 7/8" x 11 7/8" x 2 3/8"
NEVADA	301 x 301 x 60mm 11 7/8" x 11 7/8" x 2 3/8"
STANDARD 80MM	112.5 x 225 x 80mm 4 1/2" x 8 7/8" x 3 1/8"
DOUBLE STANDARD 80MM	225 x 225 x 80mm 8 7/8" x 8 7/8" x 3 1/8"

AVAILABLE COLOURS



*Special order
**Sketch represents product color only



Decorative Paving Sample

PLANT LEGEND

SYMBOL	BOTANICAL / COMMON NAME	SIZE	SPACING	QTY.	NOTES
TREES					
	CORNUS 'EDDIE'S WHITE WONDER' WHITE WONDER DOGWOOD	6cm CAL.	1.0m O.C. AVG.	4	INDIGENOUS SPECIES
	PSEUDOTSUGA MENZIESII DOUGLAS FIR	2.5m	1.0m O.C. AVG.	3	INDIGENOUS SPECIES
	TAXUS BREVIFOLIA PACIFIC YEW	#5 POT	SEE PLAN	1	INDIGENOUS SPECIES
SHRUBS					
	ACER CIRCINATUM VINE MAPLE	#3 POT	SEE PLAN	15	INDIGENOUS SPECIES
	AMELANCHIER ALNIFOLIA SASKATOON	#3 POT	SEE PLAN	3	INDIGENOUS SPECIES
	GAULTHERIA SHALLON SALAL	#1 POT	1.0m O.C.	136	INDIGENOUS SPECIES
	HOLODISCUS DISCOLOR OCEANSPRAY	#1 POT	1.0m O.C.	38	INDIGENOUS SPECIES
	POLYSTICHUM MUNITUM SWORD FERN	#1 POT	1.0m O.C.	133	INDIGENOUS SPECIES
	RIBES SANGUINEUM RED FLOWERING CURRANT	#1 POT	1.0m O.C.	81	INDIGENOUS SPECIES
	RUBUS SPECTABILIS SALMONBERRY	#1 POT	1.2m O.C.	50	INDIGENOUS SPECIES
	VACCINIUM OVATUM EVERGREEN HUCKLEBERRY	#1 POT	1.0m O.C.	132	INDIGENOUS SPECIES
GROUNDCOVER, VINES & PERENNIALS					
	ARCTOSTAPHYLOS UVA-URSI KINKKINNICK	#1 POT	0.9m O.C.	6	INDIGENOUS SPECIES
	CORNUS CANADENSIS BUNCHBERRY	#1 POT	0.6m O.C.	49	INDIGENOUS SPECIES
	DICENTRA FORMOSA PACIFIC BLEEDING HEART	#1 POT	0.6m O.C.	22	INDIGENOUS SPECIES
	LONICERA CILIOSA PACIFIC HONEYSUCKLE	#1 POT	SEE PLAN	24	INDIGENOUS SPECIES
	MAHONIA NERVOSA DULL OREGON GRAPE	#1 POT	0.6m O.C.	4	INDIGENOUS SPECIES
	LAWN: CANADA NO. 1	SOD		56sq.m.	
SLOPE RE-VEGETATION					
	CORNUS NUTTALLII PACIFIC DOGWOOD	#5 POT	6.0m O.C.	6	INDIGENOUS SPECIES
	GAULTHERIA SHALLON SALAL	#1 POT	1m O.C.	30	PLANT IN CLUSTERS OF 7, 9, 15
	MAHONIA NERVOSA DULL OREGON GRAPE	#1 POT	1m O.C.	30	
	POLYSTICHUM MUNITUM SWORD FERN	#1 POT	1m O.C.	30	
	ROSA NUTKANA NOOTKA ROSE	#1 POT	1m O.C.	30	
	RUBUS PARVIFLORUS THIMBLEBERRY	#1 POT	1m O.C.	30	
	RUBUS SPECTABILIS SALMONBERRY	#1 POT	1m O.C.	30	
	SAMBUCUS RACEMOSA RED ELDERBERRY	#1 POT	1m O.C.	30	
	SYMPHORICARPOS ALBUS SNOWBERRY	#1 POT	1m O.C.	30	
	VACCINIUM PARVIFOLIUM RED HUCKLEBERRY	#1 POT	1m O.C.	30	

SYMBOL	% BY WEIGHT	APPLICATION RATE	AREA
HYDROSEED - SUPPLIER: PREMIER PACIFIC SEEDS LTD., PH: 604-881-1323			
	SEED MIX (NATIVE SPECIES): ACHILLEA MILLEFOLIUM/YARROW AGROSTIS EXARATA/ SPIKE BENTGRASS ANAPHALIS MARGARITACEA/ PEARLY EVERLASTING BROMUS SITCHENSIS/ ALASKA BROME DESCHAMPSIA CESPIITOSA/ TUFTED HAIRGRASS FESTUCA RUBRA/ NATIVE RED FESCUE HORDEUM BRACHYANTHERUM/ MEADOW BARLEY LUPINUS POLYPHYLLUS/ BIGLEAF LUPINE	1.00 Kgf/ ha. 0.5 1.0 0.05 40.0 3.0 13.95 40.0 1.5	645 sq.m./ 0.06 ha. PLANT IN SPRING PRIOR TO MAY 30 FOR WILDFLOWER ESTABLISHMENT

IRRIGATION EQUIPMENT LEGEND

SYMBOL	MANUFACTURER	MODEL	DESCRIPTION
	TBD	TBD	"SMART" (ET) AUTOMATIC IRRIGATION CONTROLLER IN MECHANICAL ROOM OF BUILDING B1
	BY MECHANICAL	BY MECHANICAL	38mm (1.5") DOUBLE CHECK BACKFLOW PREVENTER AND WATER SUPPLY IN MECHANICAL ROOM OF BUILDING B1

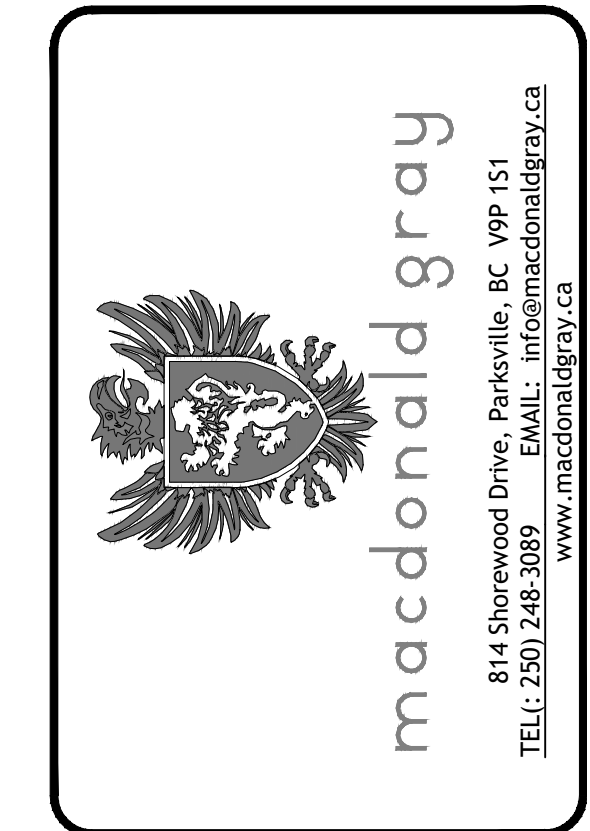

THIS DRAWING IS NOT FINAL AND SHALL NOT BE USED FOR CONSTRUCTION WORK UNTIL IT HAS BEEN STAMPED AND SIGNED BY THE LANDSCAPE ARCHITECT. THE COPYRIGHTS TO ALL DESIGNS AND DRAWINGS ARE THE PROPERTY OF MACDONALD GRAY CONSULTANTS INC. REPRODUCTION OR USE FOR ANY PURPOSE OTHER THAN THAT AUTHORIZED BY MACDONALD GRAY CONSULTANTS INC. IS FORBIDDEN.

RECEIVED
DP1357
2026-FEB-03
Current Planning

Lost Lake Cohousing Inc.
Lost Lake Cohousing Inc.
5180 Universal Place, Nanaimo, BC

LEGENDS & DETAILS

Date:	January 29, 2026
Drawn:	CM
Checked:	CM
Scale:	1:250 metric
Project Number:	23-0341
DRAWING NUMBER:	L2 of 6

REVISION SCHEDULE

#	Date	NOTES
0	03JUN2024	DP Coordination
1	19JUN2024	DP Coordination
2	25JUN2024	Issued for DP
3	10APR2025	Reissued for DP
4	29JAN2026	Reissued for DP

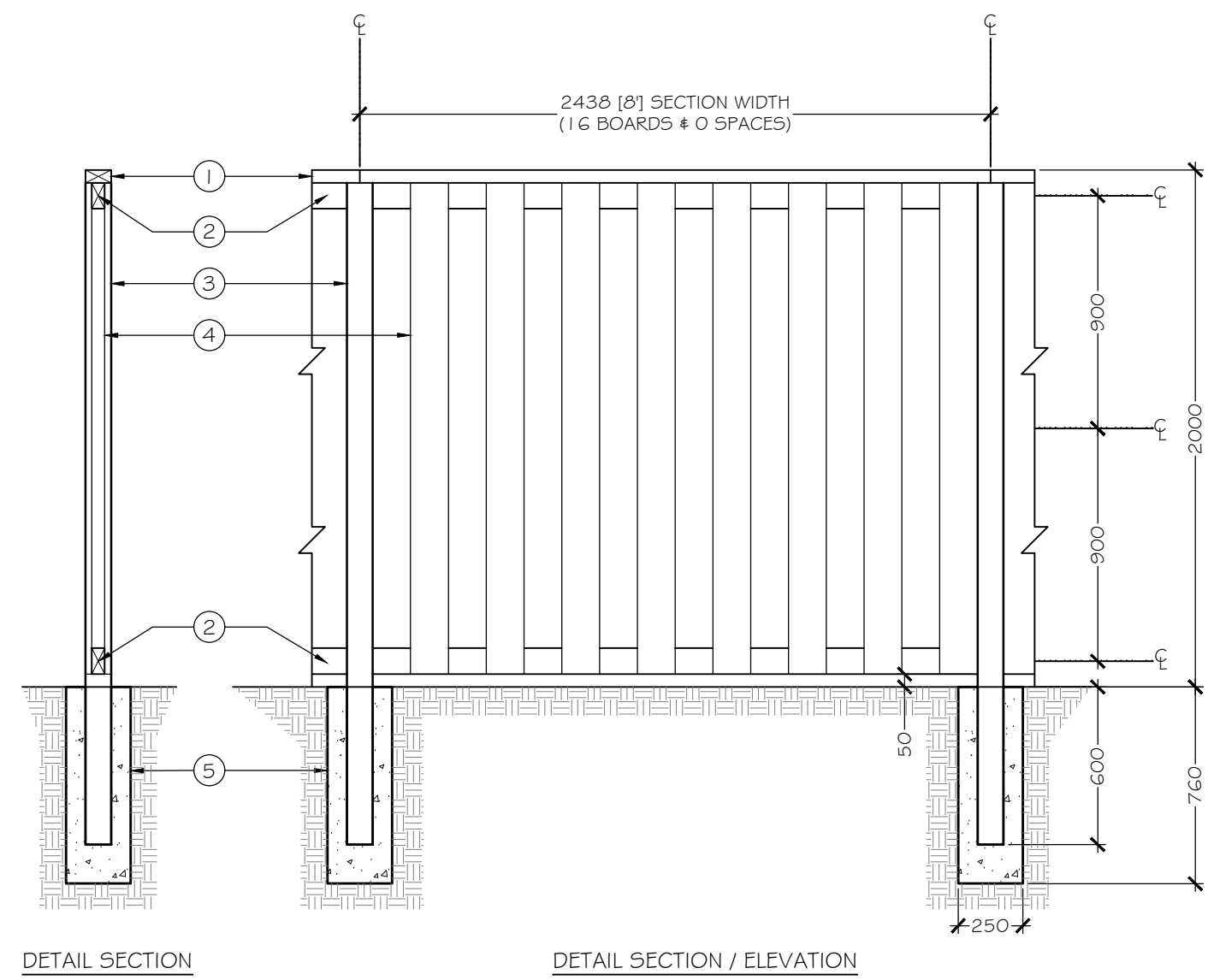

- ① 50mm X 100mm (2" X 4") CAPRAIL
- ② 50mm X 100mm (2" X 4") TOP & BOTTOM FENCE RAILS
- ③ 100mm X 100mm (4" X 4") POST
- ④ 25mm X 150mm (1" X 6") FENCE BOARD, INSTALLED ON ALTERNATE SIDES OF RAILS
- ⑤ CONCRETE FOOTING

NOTES:
1. ALL FASTENERS SHALL BE GALVANIZED

A 2.0m Timber Fence
Section/Elevation
1:25 metric

Nature Trail:

Level of use	Type of Use/Accessibility	Surface	Width	Vegetation Clearance	Slope	Horizontal curves	Barriers	Drainage	Residential Buffer	Level of Maintenance	Location	Comments/variants	Example
Low	Walking Mountain bikes & dogs Wildlife viewing (acid-washing)	Native soil with crushed higher view points.	2m (on average)	• 2m minimum horizontal clearance • 2m minimum vertical clearance	• Optimum 10% maximum 20% • 2% cross slope • Some stairs	• Ensure adequate sightlines on curves • Curves can add to the safety and character of the trail	• Primarily wooden or wood barriers • Some posts and staves or gates • Barriers at trail heads and vertical access points and, if applicable, to discourage cycles	• Minimal • Shallow • Uphill side of trail where required with and curbs at low points	10m	Low	Short access route to park and playground	• Some boardwalks • Generally in a wooded or riparian setting (sometimes environmentally sensitive areas) • Limited amenities but some garbage cans, benches and stumps • Construction with ESA's must follow environmental standards • Provide benches and rest areas at trailhead and at special features (i.e.) viewpoints	Parke Park, Woodstream Park, Cole Bay/Koon Point

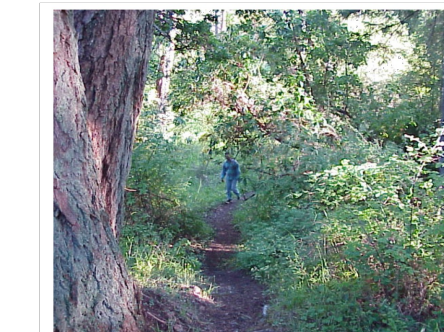

View along Parke Park trail.

Trail Concept:

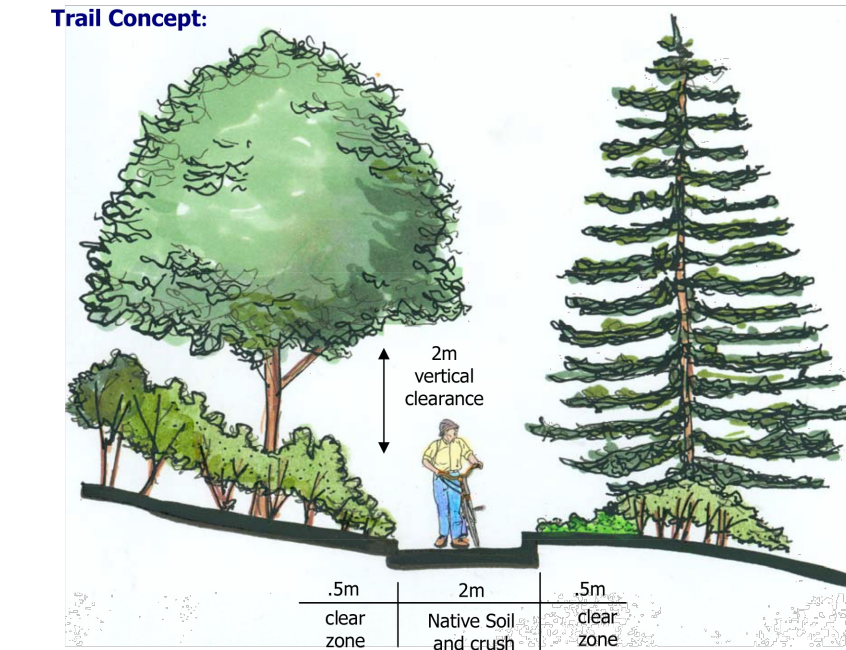

Construction Detail: Typical Trail

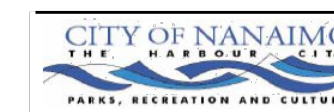
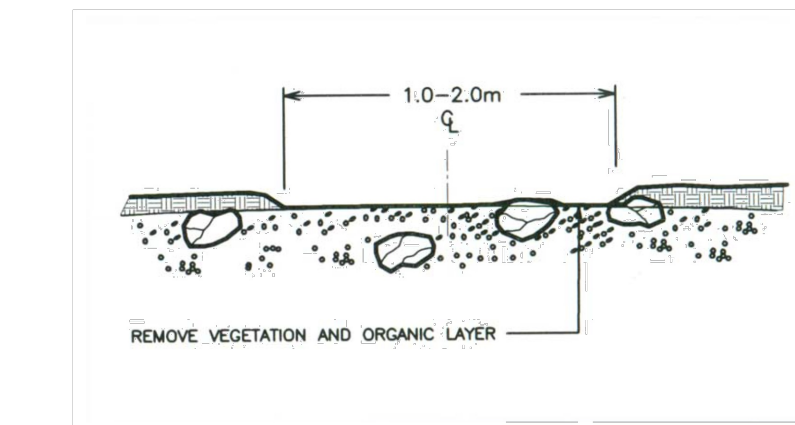

DRAFT Trail Plan: Design Guidelines
March 2007

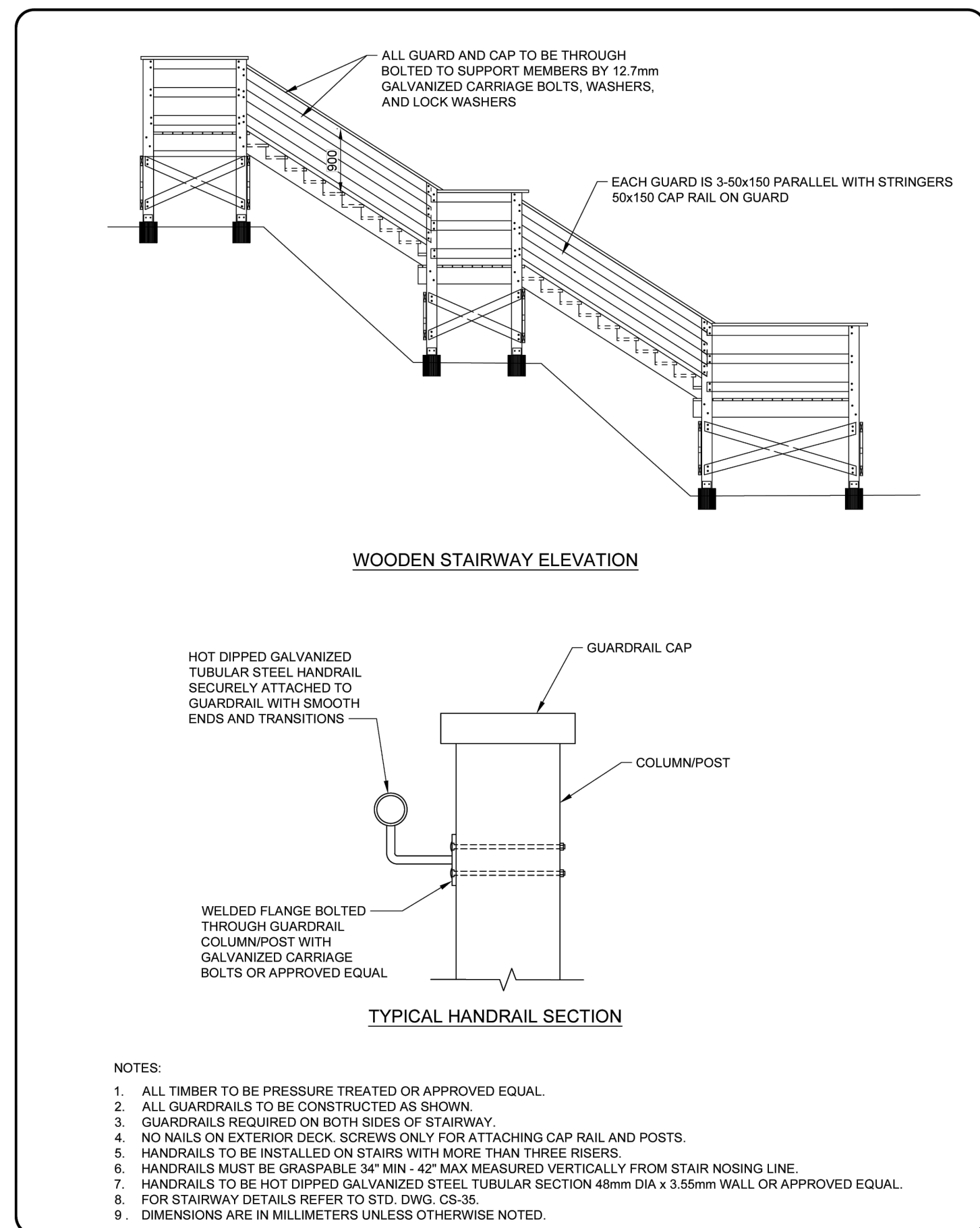

- NOTES:
- ALL TIMBER TO BE PRESSURE TREATED OR APPROVED EQUAL.
 - ALL GUARDRAILS TO BE CONSTRUCTED AS SHOWN.
 - GUARDRAILS REQUIRED ON BOTH SIDES OF STAIRWAY.
 - NO NAILS ON EXTERIOR DECK. SCREWS ONLY FOR ATTACHING CAP RAIL AND POSTS.
 - HANDRAILS TO BE INSTALLED ON STAIRS WITH MORE THAN THREE RISERS.
 - HANDRAILS MUST BE GRASPABLE 34" MIN - 42" MAX MEASURED VERTICALLY FROM STAIR NOSING LINE.
 - HANDRAILS TO BE HOT DIPPED GALVANIZED STEEL TUBULAR SECTION 48mm DIA x 3.35mm WALL OR APPROVED EQUAL.
 - FOR STAIRWAY DETAILS REFER TO STD. DWG. CS-35.
 - DIMENSIONS ARE IN MILLIMETERS UNLESS OTHERWISE NOTED.

CITY OF NANAIMO THE HARBOUR CITY
HANDRAILS AND STAIRWAYS GUARDRAIL FOR WOODEN STAIRWAY
Scale: NTS
Created: NOV 2016
Rev Date: MAY 2020
Dwg No: CS-34

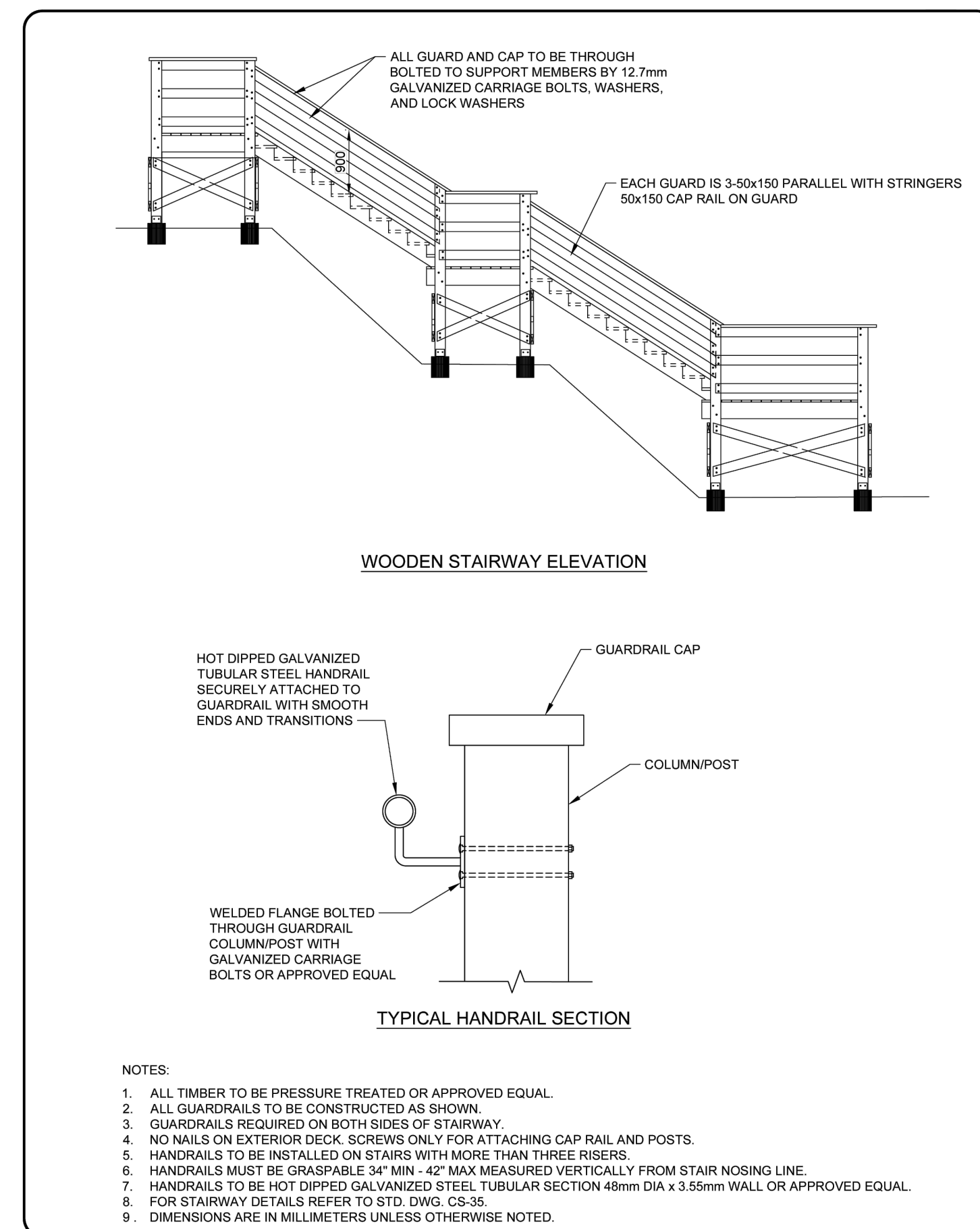

- NOTES:
- ALL TIMBER TO BE PRESSURE TREATED OR APPROVED EQUAL.
 - ALL GUARDRAILS TO BE CONSTRUCTED AS SHOWN.
 - GUARDRAILS REQUIRED ON BOTH SIDES OF STAIRWAY.
 - NO NAILS ON EXTERIOR DECK. SCREWS ONLY FOR ATTACHING CAP RAIL AND POSTS.
 - HANDRAILS TO BE INSTALLED ON STAIRS WITH MORE THAN THREE RISERS.
 - HANDRAILS MUST BE GRASPABLE 34" MIN - 42" MAX MEASURED VERTICALLY FROM STAIR NOSING LINE.
 - HANDRAILS TO BE HOT DIPPED GALVANIZED STEEL TUBULAR SECTION 48mm DIA x 3.35mm WALL OR APPROVED EQUAL.
 - FOR STAIRWAY DETAILS REFER TO STD. DWG. CS-35.
 - DIMENSIONS ARE IN MILLIMETERS UNLESS OTHERWISE NOTED.

CITY OF NANAIMO THE HARBOUR CITY
HANDRAILS AND STAIRWAYS GUARDRAIL FOR WOODEN STAIRWAY
Scale: NTS
Created: NOV 2016
Rev Date: MAY 2020
Dwg No: CS-34

PLANTING NOTES

- ALL LANDSCAPE INSTALLATION AND MAINTENANCE SHALL MEET OR EXCEED THE MOST RECENT STANDARDS SET OUT BY THE CANADIAN LANDSCAPE NURSERY ASSOCIATION (CLNA) / CANADIAN SOCIETY OF LANDSCAPE ARCHITECTS (CSLA) CANADIAN LANDSCAPE STANDARD.
- SOIL DEPTHS: SHRUBS - 450mm
TREES - 900mm AROUND AND BELOW ROOTBALL IN PLANTERS
- MULCH SHALL BE COMPOST PER SECTION 1.0 MULCHING OF THE BCNTA/BCSLA BC LANDSCAPE STANDARD. MULCH DEPTH SHALL BE 75mm MINIMUM OVER ALL TREE AND SHRUB PLANTING AREAS AND PLANTERS.
- PLANT MATERIAL QUALITY, TRANSPORT AND HANDLING SHALL COMPLY WITH BCNTA/BCSLA STANDARDS FOR NURSERY STOCK.
- ALL PLANTING AREAS SHALL BE WATERED VIA AN UNDERGROUND AUTOMATIC IRRIGATION SYSTEM. IRRIGATION EMISSION DEVICES SHALL BE LOW VOLUME ROTARY NOZZLES OR DRIP EQUIPMENT.
- ALL PLANTERS SHALL BE WATERED VIA THE AUTOMATIC IRRIGATION SYSTEM. IRRIGATION EMISSION DEVICES SHALL BE DRIP EQUIPMENT.
- PLANT QUANTITIES ARE FOR INFORMATION ONLY. IN CASE OF ANY DISCREPANCY THE PLAN SHALL GOVERN.
- ALL PLANT MATERIAL SHALL MATCH SPECIES AS INDICATED ON THE PLANTING LEGEND. CONTACT THE LANDSCAPE ARCHITECT FOR APPROVAL OF ANY SUBSTITUTIONS. NO SUBSTITUTIONS WILL BE ACCEPTED WITHOUT PRIOR WRITTEN APPROVAL OF THE LANDSCAPE ARCHITECT.
- NO PLANTS REQUIRING PRUNING OF MAJOR BRANCHES DUE TO DISEASE, DAMAGE OR POOR FORM WILL BE ACCEPTED.

IRRIGATION NOTES

- IRRIGATION SYSTEM INSTALLATION SHALL MEET OR EXCEED THE THE REQUIREMENTS SET OUT IN THE MOST CURRENT VERSION OF THE CANADIAN NURSERY LANDSCAPE ASSOCIATION (CNLA) / CANADIAN SOCIETY OF LANDSCAPE ARCHITECTS (CSLA) CANADIAN LANDSCAPE STANDARD.
- ALL PLANTING AREAS SHALL BE WATERED VIA THE UNDERGROUND AUTOMATIC IRRIGATION SYSTEM. IRRIGATION EMISSION DEVICES SHALL BE LOW VOLUME ROTARY NOZZLES OR DRIP EQUIPMENT.
- ALL PLANTERS SHALL BE WATERED VIA THE AUTOMATIC IRRIGATION SYSTEM. IRRIGATION EMISSION DEVICES SHALL BE DRIP EQUIPMENT.
- THE CONTRACTOR SHALL ADJUST THE PLACEMENT AND RADIUS OF SPRINKLERS AS REQUIRED BY FIELD CONDITIONS TO ACHIEVE FULL COVERAGE OF ALL PLANTED AREAS AND TO MINIMIZE OVER-SPRAY ONTO ADJACENT HARD SURFACES, FENCES AND PROPERTY LINES.
- ALL PIPING UNDER PAVING SHALL BE INSTALLED IN SEPARATE SCHEDULE 40 SLEEVES AT A MINIMUM DEPTH OF 600mm WITH 150mm OF SAND BACKFILL ABOVE AND BELOW PIPE. ALL WIRING UNDER PAVING SHALL BE INSTALLED IN SEPARATE SCHEDULE 40 PVC CONDUIT. ALL SLEEVES AND CONDUIT SHALL BE INSTALLED PRIOR TO PAVEMENT INSTALLATION AND SHALL EXTEND 150mm BEYOND EDGE OF PAVEMENT OR CURB. BACKFILL FOR SLEEVES SHALL BE COMPACTED TO THE SPECIFIED DENSITY FOR THE SUBGRADE.
- OPERATE IRRIGATION CONTROLLER WITHIN THE CITY OF NANAIMO WATER RESTRICTION SCHEDULE.

macdonald gray
814 Shorewood Drive, Parksville, BC V9P 1S1
TEL: 250 248-3089 EMAIL: info@macdonaldgray.ca
www.macdonaldgray.ca

THIS DRAWING IS NOT FINAL AND SHALL NOT BE USED FOR CONSTRUCTION WORK UNTIL IT HAS BEEN STAMPED AND SIGNED BY THE LANDSCAPE ARCHITECT
THE COPYRIGHTS TO ALL DESIGNS AND DRAWINGS ARE THE PROPERTY OF MACDONALD GRAY CONSULTANTS INC. REPRODUCTION OR USE FOR ANY PURPOSE OTHER THAN THAT AUTHORIZED BY MACDONALD GRAY CONSULTANTS INC. IS FORBIDDEN

RECEIVED
DP1357
2025-JUL-22
Current Planning

Lost Lake Cohousing Inc.
Lost Lake Cohousing Inc.
5180 Universal Place, Nanaimo, BC

NOTES & DETAILS
Date: April 10, 2025
Drawn: CM
Checked: CM
Scale: 1:250 metric
Project Number: 24-0341
DRAWING NUMBER: L3 of 6

REVISION SCHEDULE	DATE	NOTES
#	Date	NOTES
0	03JUN2024	DP Coordination
1	19JUN2024	DP Coordination
2	25JUN2024	Issued for DP
3	10APR2025	Reissued for DP

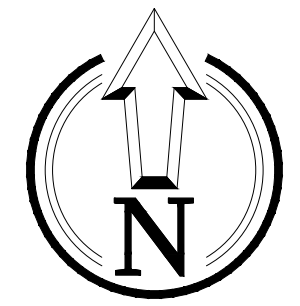
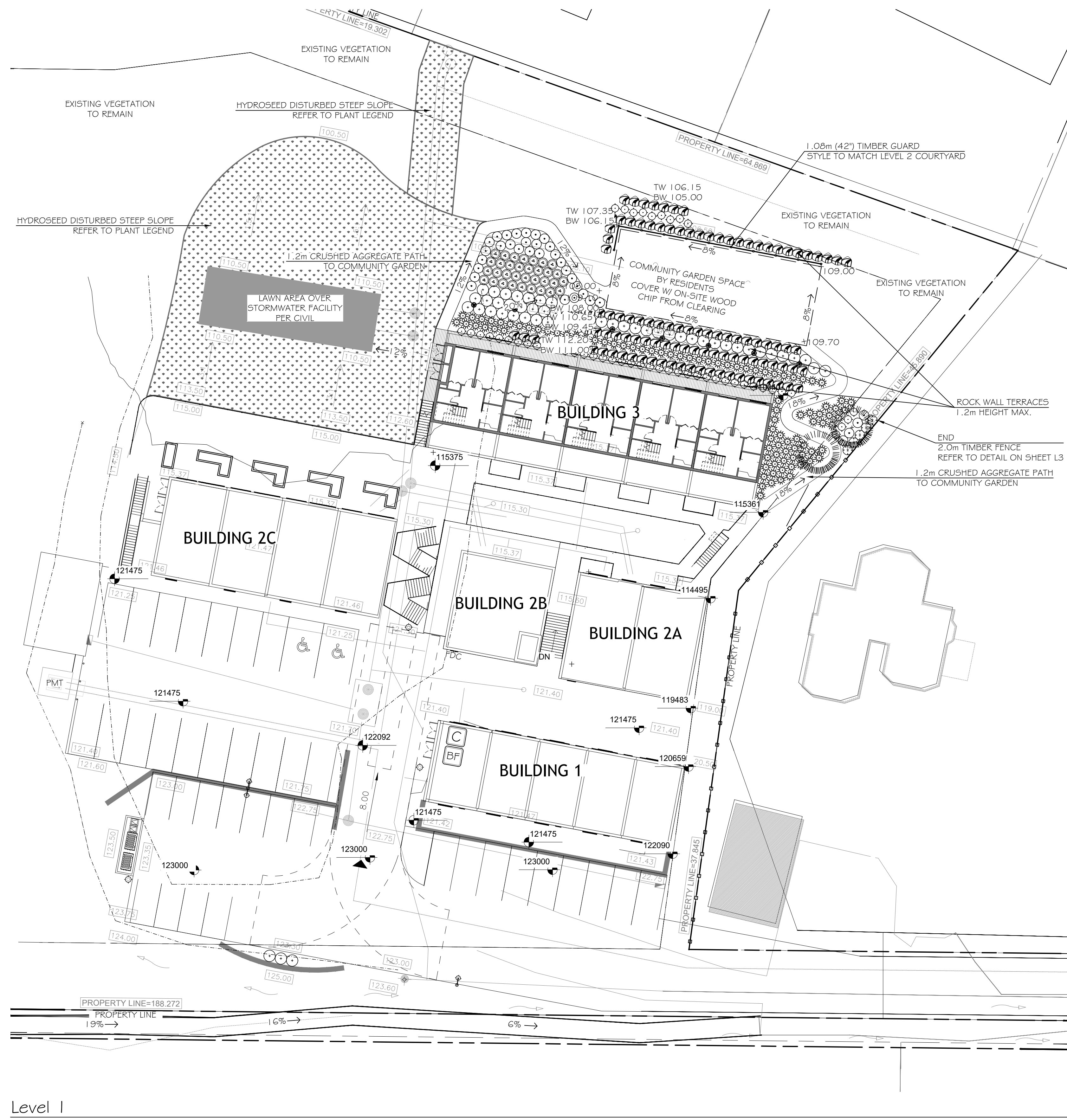

#	Date	NOTES
0	03 JUN 2024	DP Coordination
1	19 JUN 2024	DP Coordination
2	25 JUN 2024	Issued for DP
3	10 APR 2025	Reissued for DP

LEVEL 1 PLAN	
Date:	April 10, 2025
Drawn:	CM
Checked:	CM
Scale:	1:250 metric
Project Number:	24-0341
DRAWING NUMBER:	L4 of 6

Lost Lake Cohousing Inc.
Lost Lake Cohousing Inc.
 5180 Universal Place, Nanaimo, BC

RECEIVED
DP1357
2025-JUL-22
 Current Planning

THIS DRAWING IS NOT FINAL AND SHALL NOT BE USED FOR CONSTRUCTION WORK UNTIL IT HAS BEEN STAMPED AND SIGNED BY THE LANDSCAPE ARCHITECT. THE COPYRIGHTS TO ALL DESIGNS AND DRAWINGS ARE THE PROPERTY OF MACDONALD GRAY CONSULTANTS INC. REPRODUCTION OR USE FOR ANY PURPOSE OTHER THAN THAT AUTHORIZED BY MACDONALD GRAY CONSULTANTS INC. IS FORBIDDEN.

macdonald gray
 814 Shorewood Drive, Parksville, BC V9P 1S1
 TEL: 250-248-3089 EMAIL: info@macdonaldgray.ca
 www.macdonaldgray.ca

- ① 25mm X 100mm (1" X 4") GATE FRAME
- ② 25mm X 150mm (1" X 6") FENCE BOARDS PLACED TIGHT
- ③ 25mm X 150mm (1" X 6") CROSS BRACE
- ④ 150mm X 150mm (6" X 6") POST, TYP. OF (5) PLACES, REFER TO DETAIL CL4 FOR FOOTINGS
- ⑤ 600mm CANE BOLT, BLACK POWDERCOAT FINISH AND BOLT SLEEVE LOCATIONS
- ⑥ HEAVY DUTY GATE HINGE (J-BOLT STYLE), BLACK POWDERCOAT FINISH
- ⑦ 62.5mm X 300mm X 300mm - 7GA CORNER STRAP TIE, BOLTED IN PLACE
- ⑧ HEAVY DUTY LOCKABLE PIN BOLT STYLE LATCH, BLACK POWDERCOAT FINISH
- ⑨ CONCRETE PAD
- ⑩ SIDES OF ENCLOSURE, REFER TO DETAIL A1.3
- ⑪ METAL BOLLARDS

NOTES:
 1. ALL TIMBERS SHALL BE CEDAR.
 2. ALL FASTENERS SHALL BE GALVANIZED.
 3. APPLY EXTERIOR TRANSLUCENT CEDAR STAIN ON ALL TIMBERS

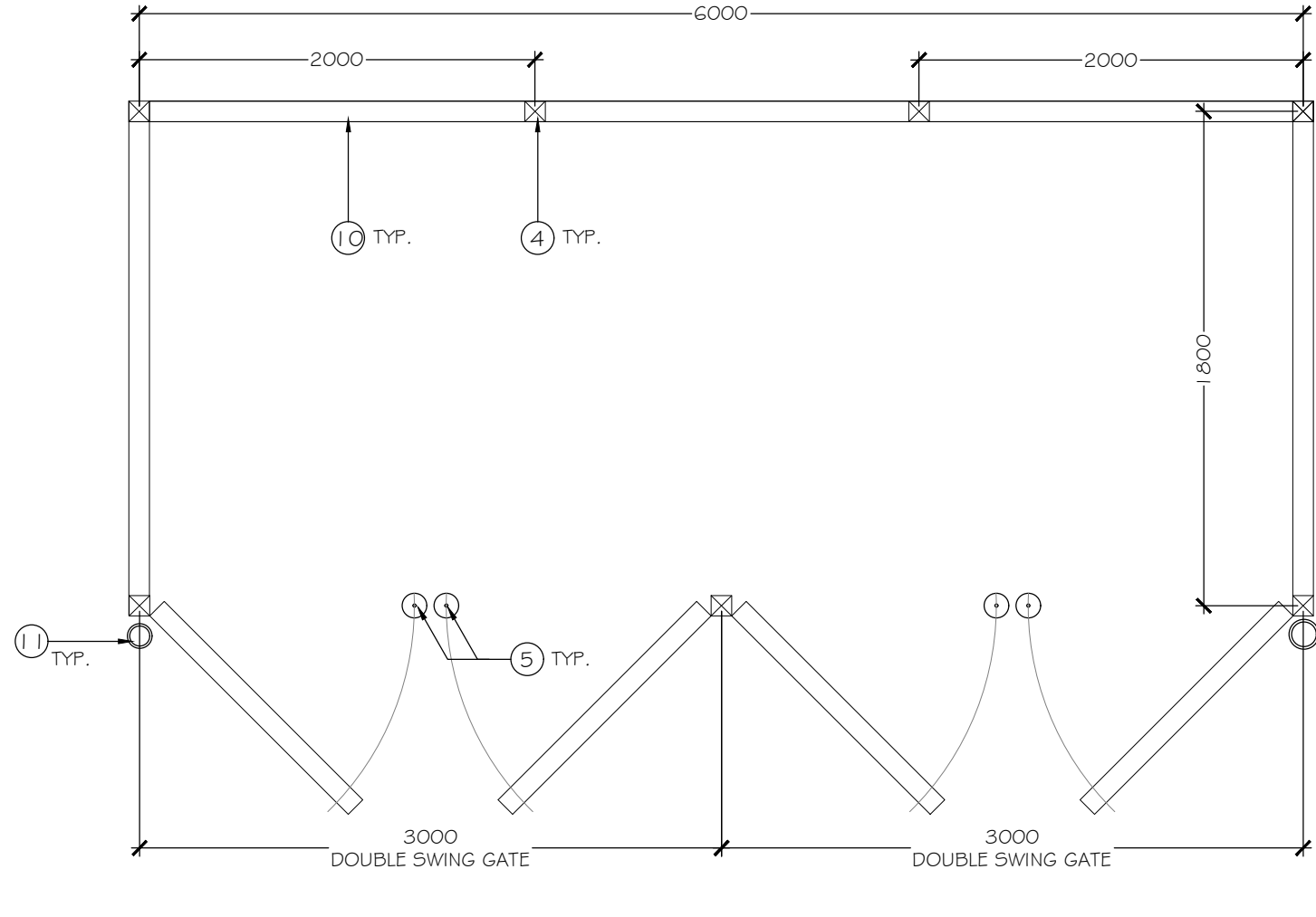
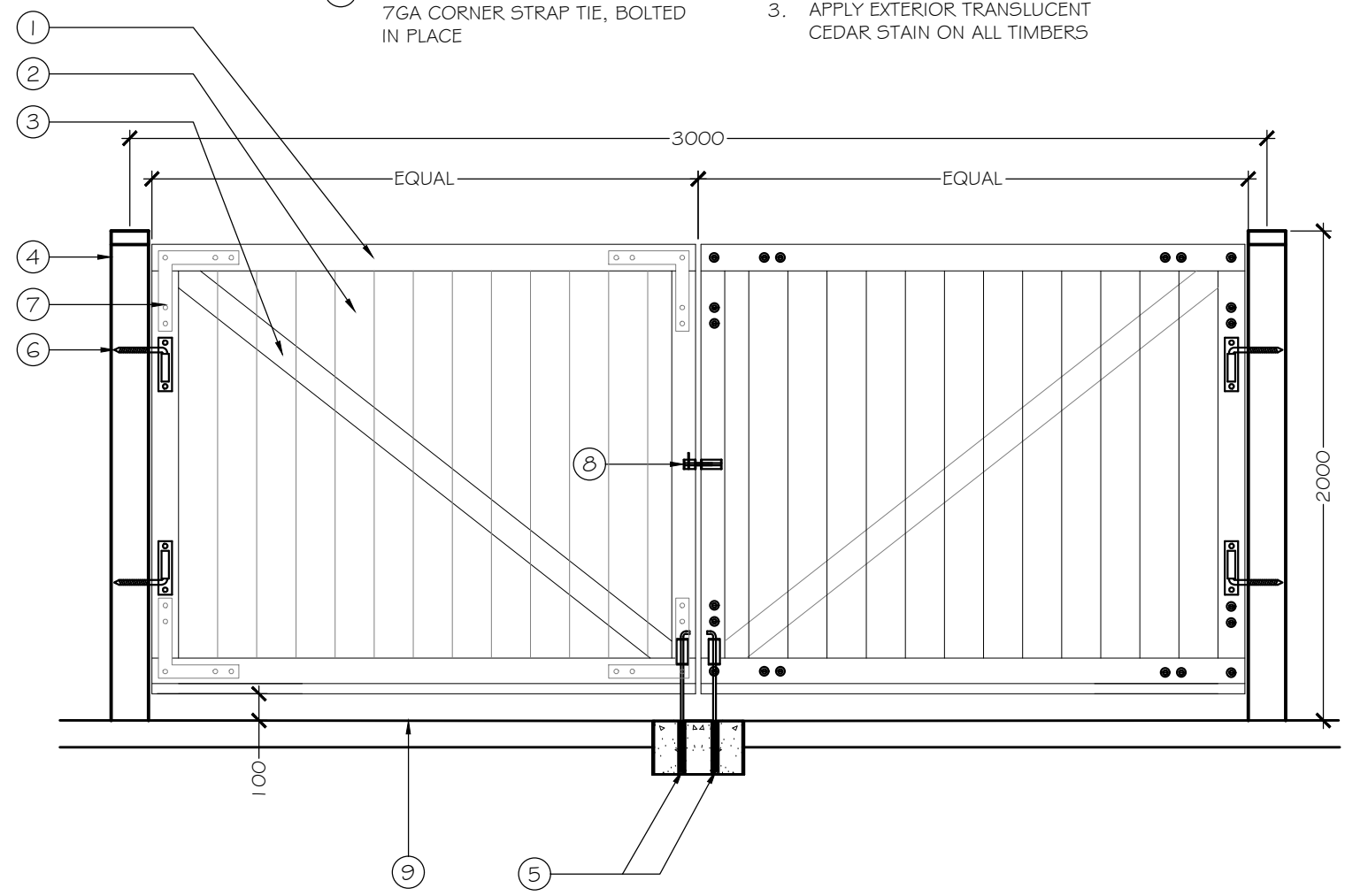

A 2.0m Garbage Enclosure
 Plan/ Elevation

Not to Scale

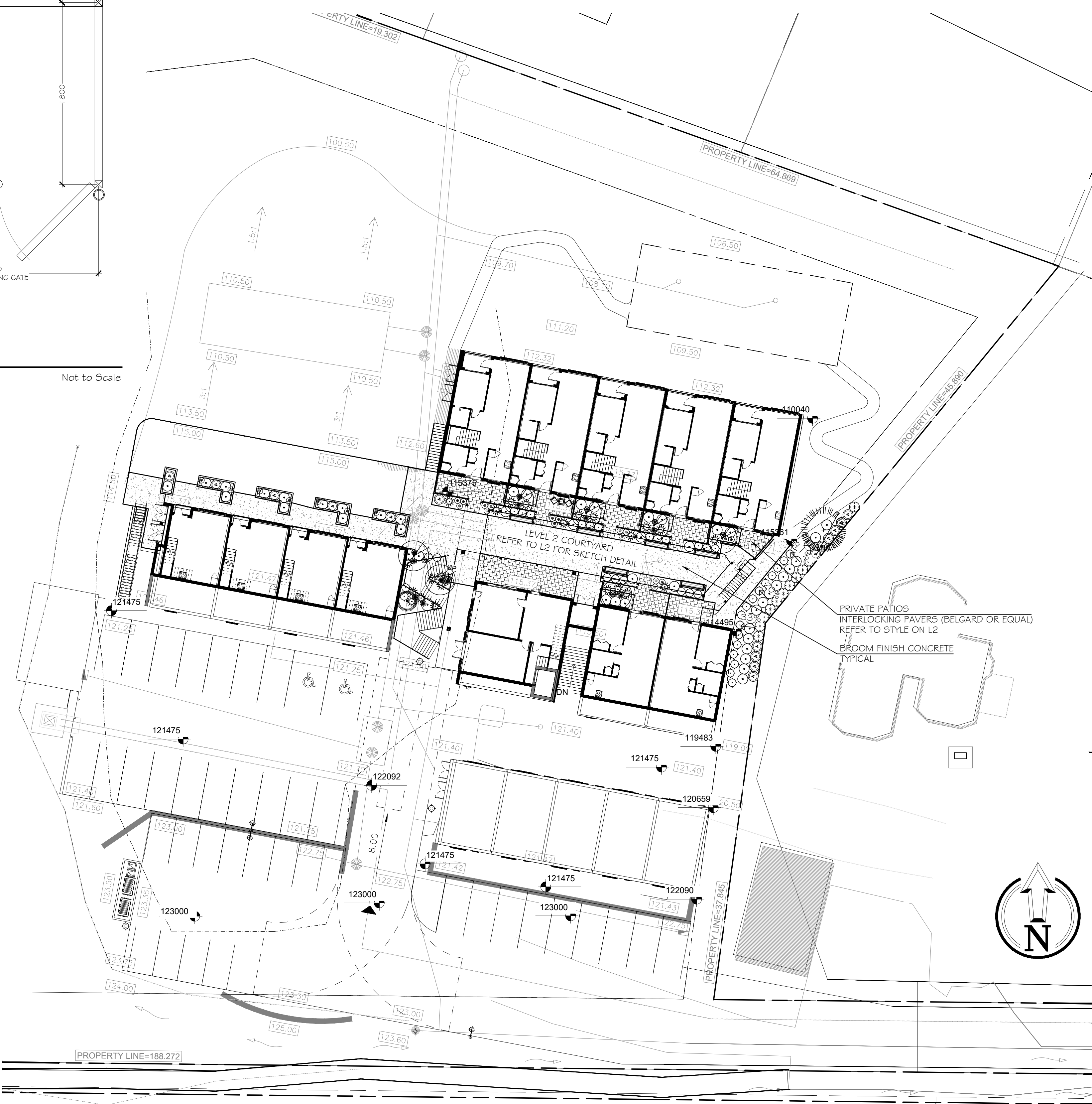

Level 2

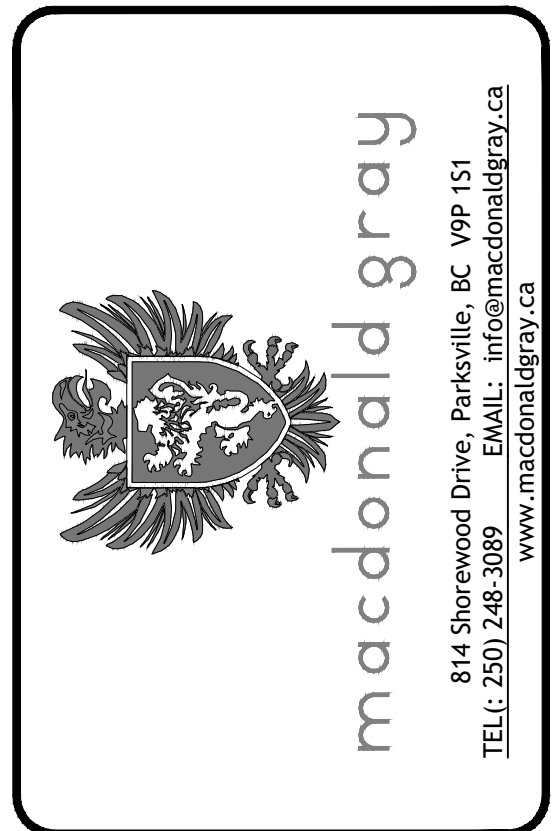

THIS DRAWING IS NOT FINAL AND SHALL NOT BE USED FOR CONSTRUCTION WORK UNTIL IT HAS BEEN STAMPED AND SIGNED BY THE LANDSCAPE ARCHITECT. THE COPYRIGHTS TO ALL DESIGNS AND DRAWINGS ARE THE PROPERTY OF MACDONALD GRAY CONSULTANTS INC. REPRODUCTION OR USE FOR ANY PURPOSE OTHER THAN THAT AUTHORIZED BY MACDONALD GRAY CONSULTANTS INC. IS FORBIDDEN.

RECEIVED
DP1357
 2025-JUL-22
 Current Planning

Lost Lake Cohousing Inc.
 5180 Universal Place, Nanaimo, BC

LEVEL 2 PLAN & DETAIL

Date:	April 10, 2025
Drawn:	CM
Checked:	CM
Scale:	1:250 metric
Project Number:	24-0341
DRAWING NUMBER:	L5 of 6

#	Date	NOTES
0	03JUN2024	DP Coordination
1	19JUN2024	DP Coordination
2	25JUN2024	Issued for DP
3	10APR2025	Reissued for DP

